



JAPAN MACHINERY COMPANY

Overseas Operations Division

Resistance film 4 point probe tester
(Japan)



2016



JAPAN MACHINERY COMPANY

Resistance film 4 point probe tester

- | | |
|--------------------------------------|----------------------------------------------------------------------------------------|
| 1. Method of measurement: | Four parallel electrodes measurement |
| 2. Measurement range: | 20Ω/□: 0.30Ω/□ ~ 19.99Ω/□
200Ω/□: 3.0Ω/□ ~ 199.9Ω/□ |
| 3. Measured width recommended range: | |
| For 4mm electrode: | For 8mm electrode: |
| 20Ω/□: 0.30~4.00mm | 20Ω/□: 0.30~8.00mm |
| 200Ω/□: 1.0~4.0mm | 200Ω/□: 1.0~8.0mm |
| 4. Indication: | Digital display panel |
| 5. Total accuracy: | Within 1% |
| 6. Ambient temperature: | 10 - 30° C |
| 7. Power source: | AC95 ~ 110V (changeable) |
| 8. Dimensions: | Tester: 192H × 160W × 260D
Electrode: small-size, width is 4mm,
8mm (switchable) |
| 9. Calibrator: | 10.000 ± 0.005Ω (at room temperature) |
| 10. Others: | Performance improving is possible |





JAPAN MACHINERY COMPANY

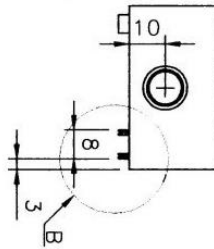
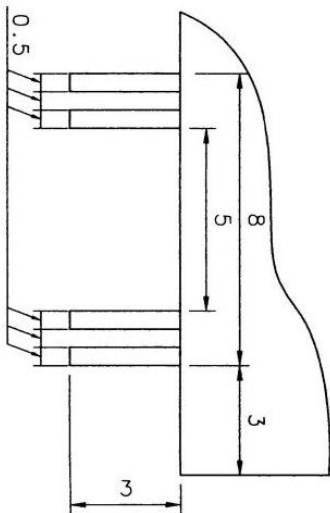
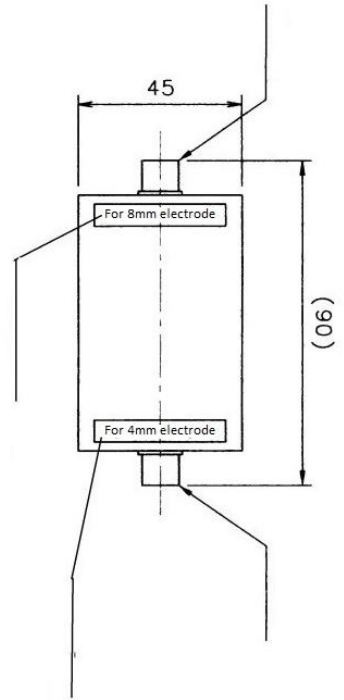
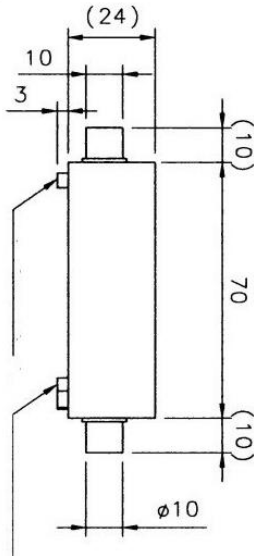
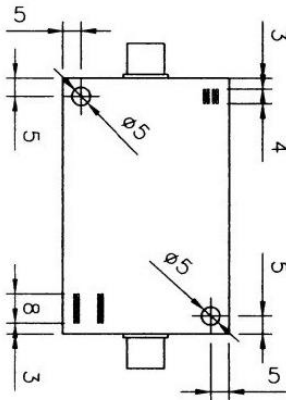
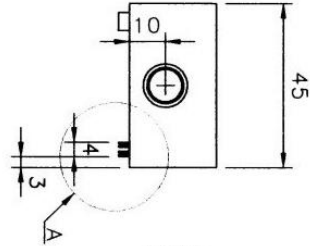
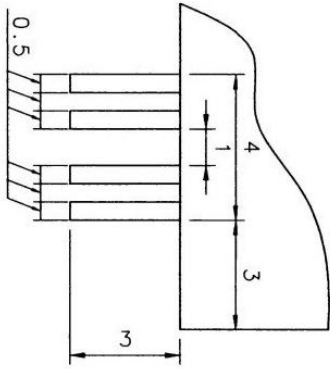



JAPAN MACHINERY COMPANY

